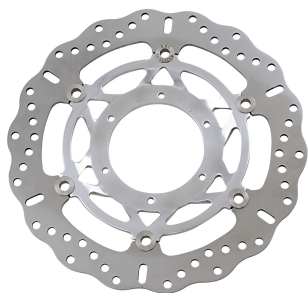

Tarcza hamulcowa EBC MD1141CC HONDA CBR 600 F4I CB

Cena :
1858,00 zł
 Nr katalogowy : **MD1141CC**
 Producent : **EBC**
 Stan magazynowy : **bardzo wysoki**
 Średnia ocena :

Tarcza hamulcowa EBC MD1141CC HONDA CBR 600 F4I CB 900

COLOR/FINISH Polished
 MATERIAL Billet Steel
 MODEL Pro-Lite Series
 OUTSIDE DIAMETER 296 mm (11-21/32")
 SHAPE Contour
 TYPE Two Piece (Floating)
 UNITS Each
 PRODUCT NAME Brake Rotor
 MOUNTING POSITION Front
 BRAKING SURFACE Drilled
 BASE FINISH Polished

Firma EBC to jeden z największych europejskich producentów okładzin i tarcz hamulcowych.
 Tarcze prosimy wymieniać parami, bowiem mogą one nieznacznie odbiegać wyglądem od oryginalnych.
 Tarcze prosimy wymieniać w wyspecjalizowanych warsztatach motocyklowych!!!

Model Displacement Year Country Engine Info Position

HONDA CBR 600 F 599 2001 EUROPE 25 KW(34 PS); 72 KW(98 PS); 80 KW(109 PS) Front Left/Front Right
 HONDA CBR 600 F 599 2002 EUROPE 25 KW(34 PS); 72 KW(98 PS); 80 KW(109 PS) Front Left/Front Right
 HONDA CBR 600 F 599 2003 EUROPE 25 KW(34 PS); 72 KW(98 PS); 80 KW(109 PS) Front Left/Front Right
 HONDA CBR 600 F 599 2004 EUROPE 25 KW(34 PS); 72 KW(98 PS); 80 KW(109 PS) Front Left/Front Right
 HONDA CBR 600 F 599 2005 EUROPE 25 KW(34 PS); 72 KW(98 PS); 80 KW(109 PS) Front Left/Front Right
 HONDA CBR 600 F 599 2006 EUROPE 25 KW(34 PS); 72 KW(98 PS); 80 KW(109 PS) Front Left/Front Right
 HONDA CB 900 F Hornet 919 2002 ALL 80 KW(109 PS) Front Left/Front Right
 HONDA CB 900 F Hornet 919 2003 ALL 80 KW(109 PS) Front Left/Front Right
 HONDA CB 900 F Hornet 919 2004 ALL 80 KW(109 PS) Front Left/Front Right
 HONDA CB 900 F Hornet 919 2005 ALL 80 KW(109 PS) Front Left/Front Right
 HONDA CB 900 F Hornet 919 2006 ALL 80 KW(109 PS) Front Left/Front Right
 HONDA CBR 600 F4I 599 2001 AMERICA Front Left/Front Right
 HONDA CBR 600 F4I 599 2002 AMERICA Front Left/Front Right
 HONDA CBR 600 F4I 599 2003 AMERICA Front Left/Front Right
 HONDA CBR 600 F4I 599 2004 AMERICA Front Left/Front Right
 HONDA CBR 600 F4I 599 2005 AMERICA Front Left/Front Right
 HONDA CBR 600 F4I 599 2006 AMERICA Front Left/Front Right
 HONDA CBR 600 FS Sport 599 2001 EUROPE 80 KW(109 PS) Front Left/Front Right
 HONDA CBR 600 FS Sport 599 2002 EUROPE 80 KW(109 PS) Front Left/Front Right
 HONDA VTX 1800 C 1795 2001 ALL 79 KW(107 PS) Front Left/Front Right
 HONDA VTX 1800 C 1795 2002 ALL 79 KW(107 PS) At linked brake system fit all three sets at pad change. Front Left/Front Right
 HONDA VTX 1800 C 1795 2003 ALL 79 KW(107 PS) At linked brake system fit all three sets at pad change. Front Left/Front Right
 HONDA VTX 1800 C 1795 2004 ALL 79 KW(107 PS) At linked brake system fit all three sets at pad change. Front Left/Front Right
 HONDA VTX 1800 C 1795 2005 ALL 79 KW(107 PS) At linked brake system fit all three sets at pad change. Front Left/Front Right
 HONDA VTX 1800 C 1795 2006 ALL 79 KW(107 PS) At linked brake system fit all three sets at pad change. Front Left/Front Right
 HONDA VTX 1800 C 1795 2007 AMERICA At linked brake system fit all three sets at pad change. Front Left/Front Right